

EVO Lite series

Schnellstartanleitung
Guide de démarrage rapide
Quick Start Guide

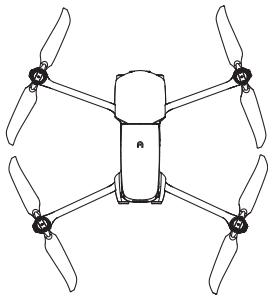

AUTEL
ROBOTICS

1 Herunterladen / Télécharger / Download



Autel Sky App



Autel Sky App



2 Aufladen / Charge / Charge

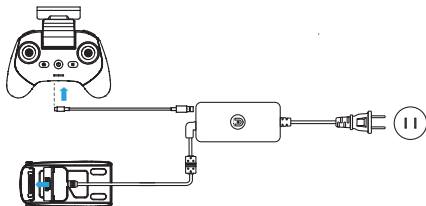

Drücken und halten Sie die Auslösetasten auf beiden Seiten des Akkus, stecken Sie das Ladekabel in den Ladeschacht des Flugzeugakku.

Appuyez sur les brides des deux côtés de la batterie, branchez le câble de charge dans la fente de charge de la batterie.

Press and hold the release button on both sides of battery and connect the battery to the adapter.

3 Bereiten Sie das Flugzeug vor / Préparation de l'appareil / Prepare the aircraft

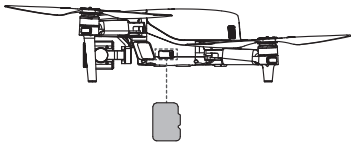
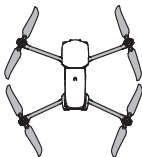
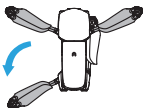
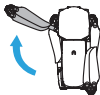
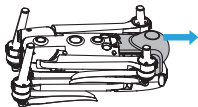

4 Bereiten Sie die Fernbedienung vor /
Préparation de la radiocommande /
Prepare the remote control

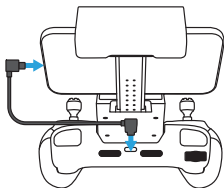
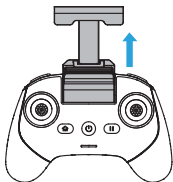

5 Einschalten / Allumer / Power on

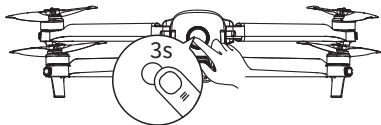

6 Motoren starten (Modus 2) / Démarrage des moteurs (Mode 2) / Start motors (Mode 2)

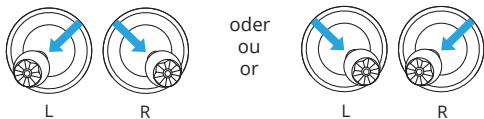

7 Abheben (Modus 2) / Décollage (Mode 2) / Take off (Mode 2)

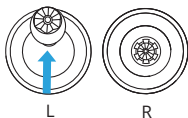

8 Landung (Modus 2) / Atterrissage (Mode 2) / Landing (Mode 2)

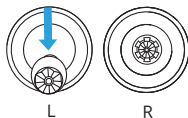

Lesen Lesen Sie alle Dokumente vor Ihrem ersten Flug.
Veuillez lire tout le manuel avant la première utilisation.
Please read all documentation before your first flight.

9 Joystick-Steuerungsmethode (Modus 2) / Mode de joystick (Mode 2) / Joystick controls (Mode 2)

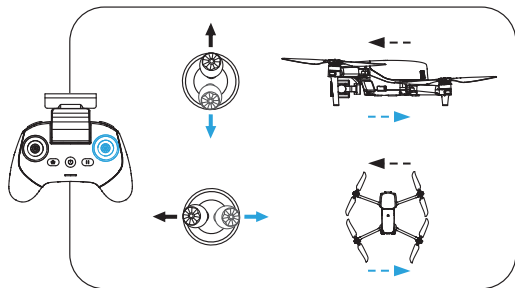
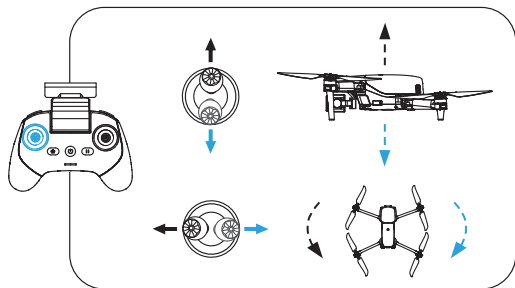

For more details, see the user manual at:
www.autelrobotics.com/download/67

Subscribe for more information

